

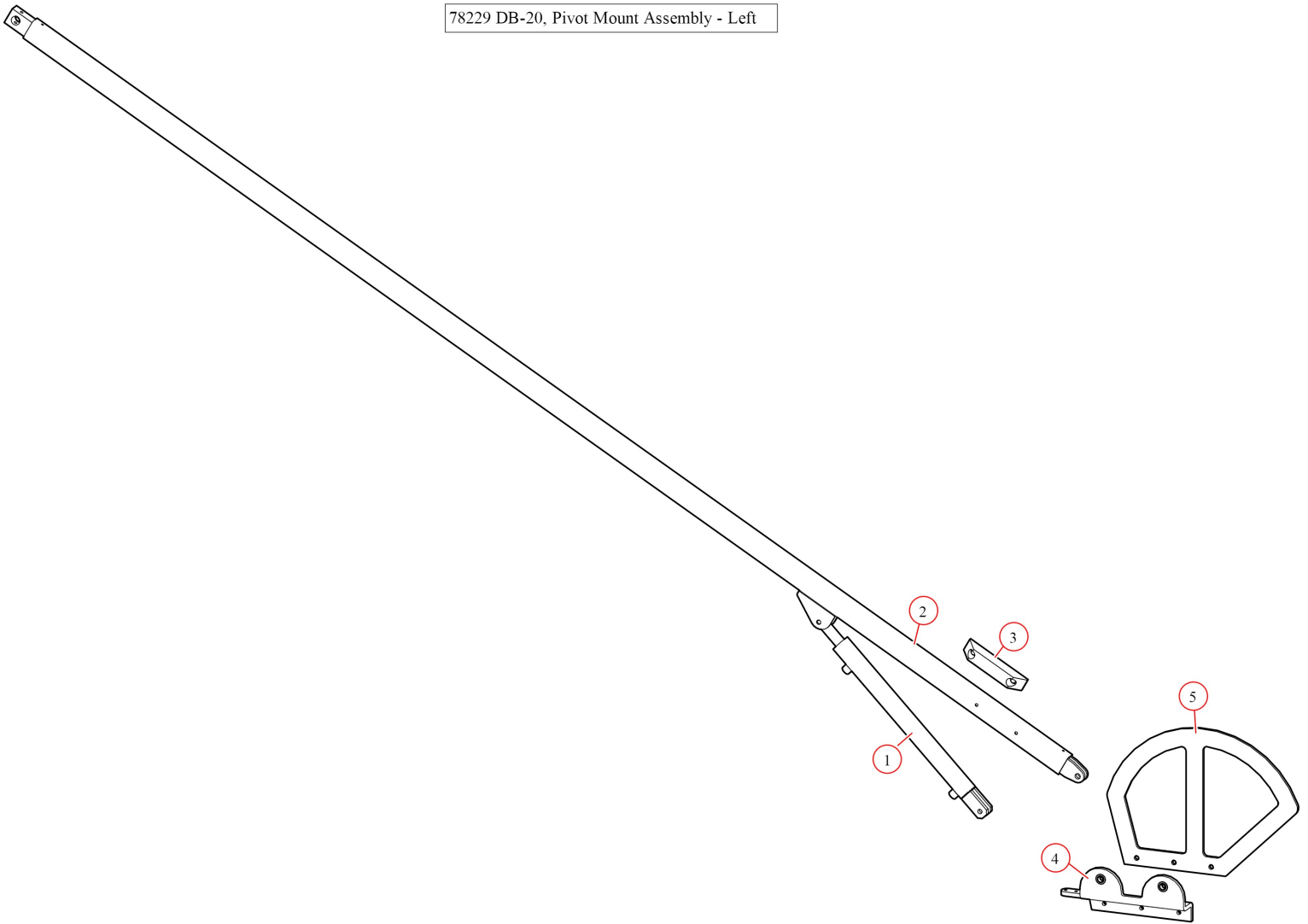

[DB-20. Pivot Mount Assembly - Left](#)

**Part Number: 78829**

78229 DB-20, Pivot Mount Assembly - Left



Bom ID	Part#	Description	qty
1	78778	Cylinder. 1.75" Bore x 17" Stroke DA Cyl. for DB-20(CN-176)	1
2	78423	Arm. DB-20	1
3	79820	UHMW. Guide Assembly w/ Hardware (ALCGH)	1
4	79450	Pivot Mount. Left DB-20 w/ Bearings (DB20PML)	1
5	78538	Bracket. Arch 3/8" (ALC-014)	1