

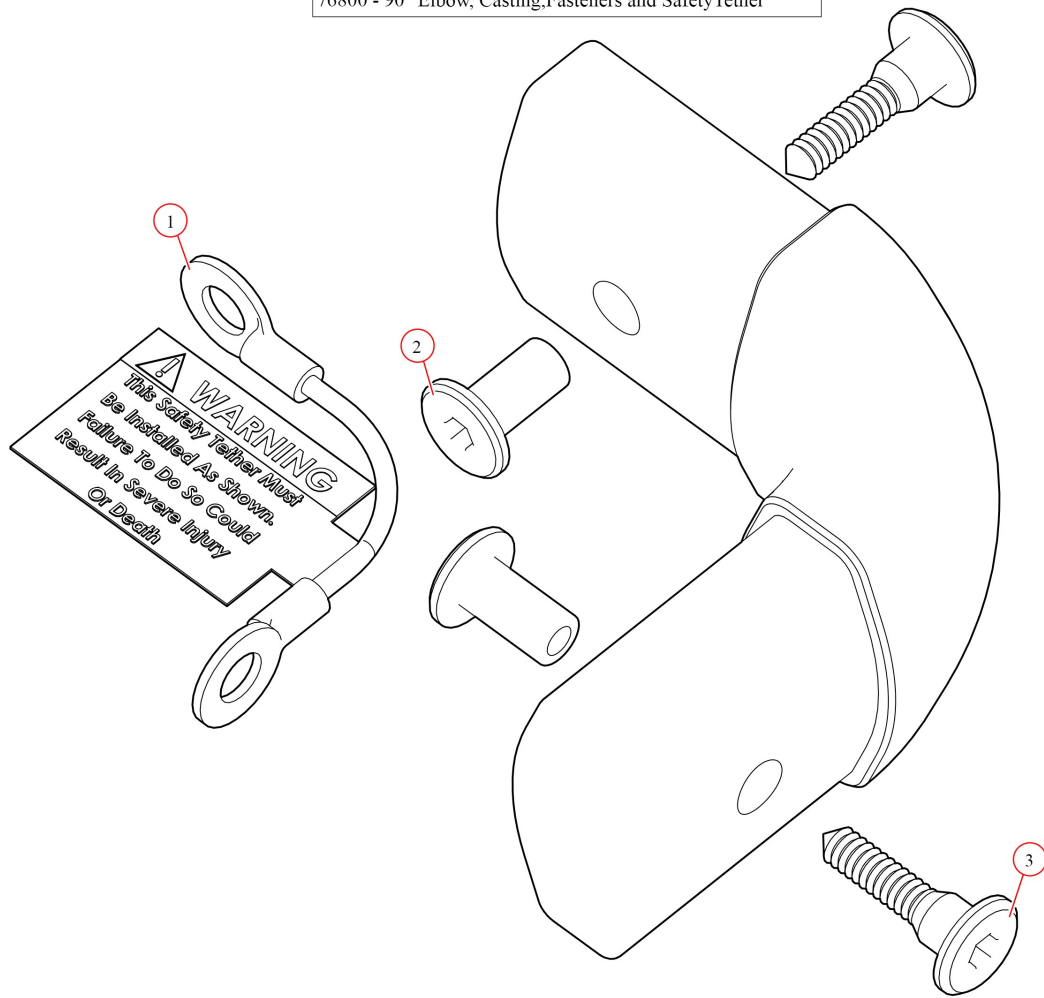

Casting. Aluminum Corner - 90 Degree With Fasteners and Tether

Part Number: 76800

76800 - 90° Elbow, Casting, Fasteners and Safety Tether



| Bom ID | Part# | Description | qty |
|--------|--------|---|-----|
| 1 | 103533 | Tether. Cable with Install Label for 90 degree corner | 1 |
| 2 | 18719 | Nut. 1/4-20 Cap Conn Nut Clear Zinc - Post bolt for 90 degree corne... | 2 |
| 3 | 18718 | Bolt. 1/4-20 x 1 3/16 Bolt Clear Zinc - Post bolt for 90 degree corners | 2 |